

# ECHO-MAGNETIC BUZZER

B8 SERIES

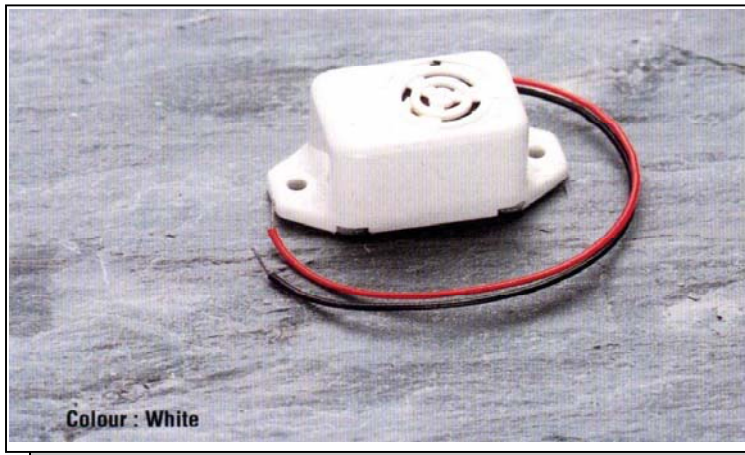

## FEATURES:

- Low pitch sound ( $400\pm 100\text{Hz}$ )
- Medium to loud sound output
- Screw mounting with leadwire terminals
- Operating temperature  $-20^{\circ}\text{C}$ --- $+70^{\circ}\text{C}$
- Storage temperature  $-30^{\circ}\text{C}$ --- $+70^{\circ}\text{C}$

## DIMENSIONS: (unit: mm)

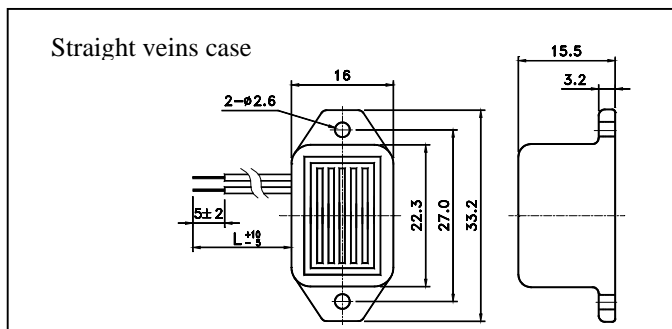
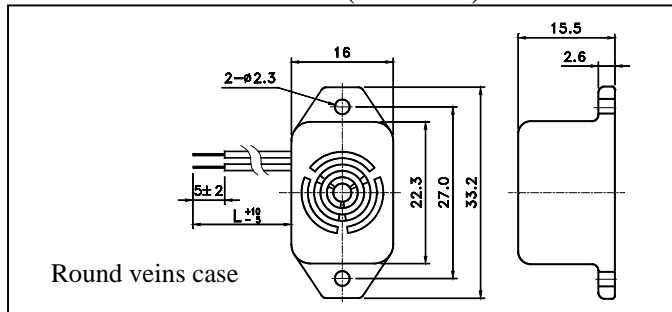

## CHARACTERISTICS:

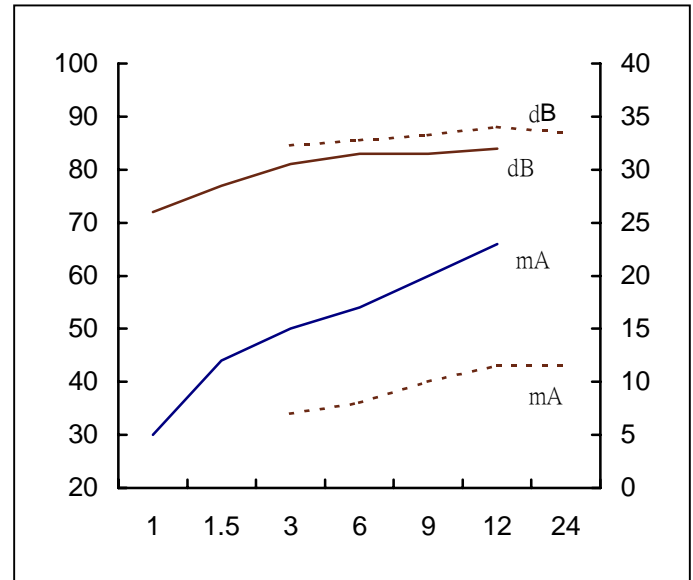

Remark: — Standard    - - - - - Hi Current

L=110mm, standard (changes as your request)

## SPECIFICATIONS:

Model No.	Operating Voltage (VDC)	Rated Voltage (VDC)	Max. Current at Rated Voltage (mA)	Min. Sound Pressure at Rated Voltage (dBA/20cm)	Tone	Terminal	Remarks
B8S1015L	1.1-1.7	1.5	20	75	SINGLE	LEAD	STANDARD
B8S1030L	1.5-4	3	20	80	SINGLE	LEAD	STANDARD
B8S1030L	1.5-4	3	40	84	SINGLE	LEAD	HI CURRENT
B8S1060L	3-9	6	20	80	SINGLE	LEAD	STANDARD
B8S1060L	3-9	6	40	85	SINGLE	LEAD	HI CURRENT
B8S1090L	4.5-12	9	25	80	SINGLE	LEAD	STANDARD
B8S1090L	4.5-12	9	45	86	SINGLE	LEAD	HI CURRENT
B8S1120L	6-16	12	25	80	SINGLE	LEAD	STANDARD
B8S1120L	6-16	12	45	87	SINGLE	LEAD	HI CURRENT
B8S1240L	8-30	24	45	85	SINGLE	LEAD	STANDARD

# ECHO-MAGNETIC BUZZER

B8 SERIES



## FEATURES:

- Low pitch sound ( $400\pm 100\text{Hz}$ )
- Medium to loud sound output
- Operating temperature  $-20^{\circ}\text{C}$ --- $+70^{\circ}\text{C}$
- Storage temperature  $-30^{\circ}\text{C}$ --- $+70^{\circ}\text{C}$

## DIMENSIONS: (unit: mm)

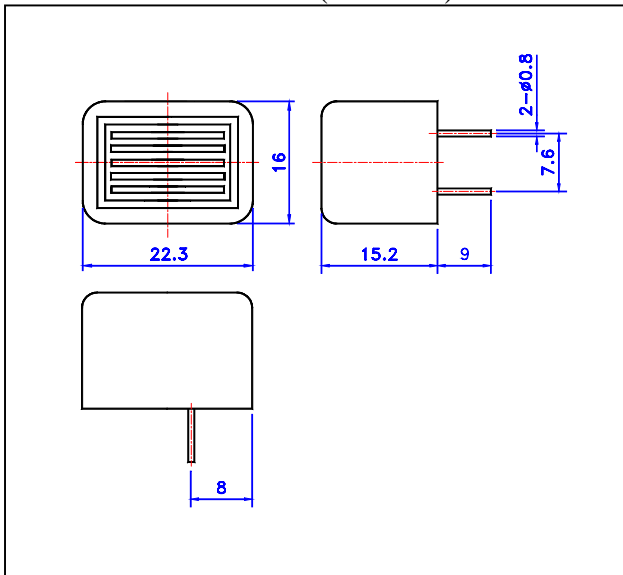

## CHARACTERISTICS:

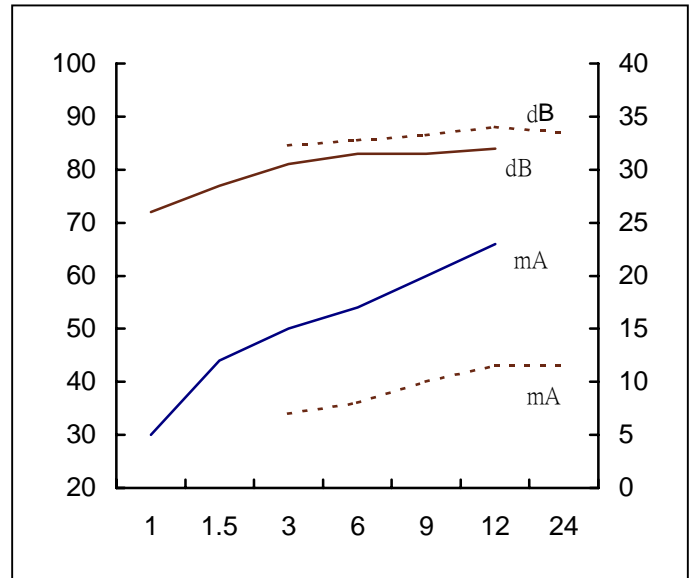

Remark: — Standard ----- Hi Current

## SPECIFICATIONS:

Model No.	Operating Voltage (VDC)	Rated Voltage (VDC)	Max. Current at Rated Voltage (mA)	Min. Sound Pressure at Rated Voltage (dBA/20cm)	Tone	Terminal	Remarks
B8S1015P	1.1-1.7	1.5	20	75	SINGLE	PIN	STANDARD
B8S1030P	1.5-4	3	20	80	SINGLE	PIN	STANDARD
B8S1030P	1.5-4	3	40	80	SINGLE	PIN	HI CURRENT
B8S1060P	3-9	6	20	80	SINGLE	PIN	STANDARD
B8S1060P	3-9	6	40	80	SINGLE	PIN	HI CURRENT
B8S1090P	4.5-12	9	25	80	SINGLE	PIN	STANDARD
B8S1090P	4.5-12	9	45	86	SINGLE	PIN	HI CURRENT
B8S1120P	6-16	12	25	80	SINGLE	PIN	STANDARD
B8S1120P	6-16	12	45	87	SINGLE	PIN	HI CURRENT
B8S1240P	8-30	24	45	85	SINGLE	PIN	STANDARD

# ECHO-MAGNETIC BUZZER

B8 SERIES

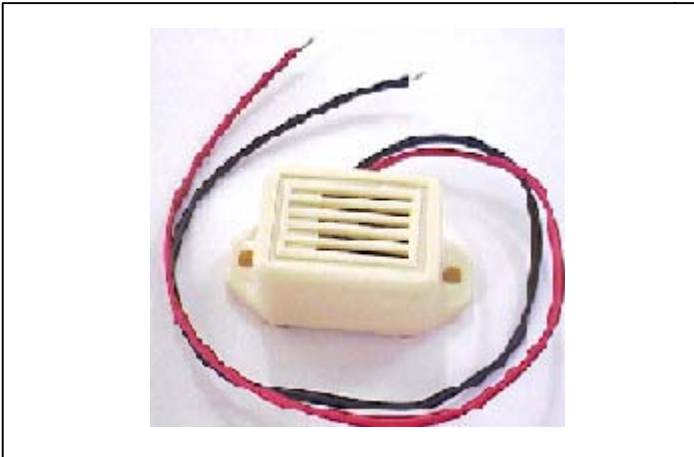

## FEATURES:

- Low pitch sound ( $400\pm 100\text{Hz}$ )
- Medium to loud sound output
- Screw mounting with leadwire terminals
- Operating temperature  $-20^{\circ}\text{C}$ --- $+70^{\circ}\text{C}$
- Storage temperature  $-30^{\circ}\text{C}$ --- $+70^{\circ}\text{C}$

## DIMENSIONS: (unit: mm)

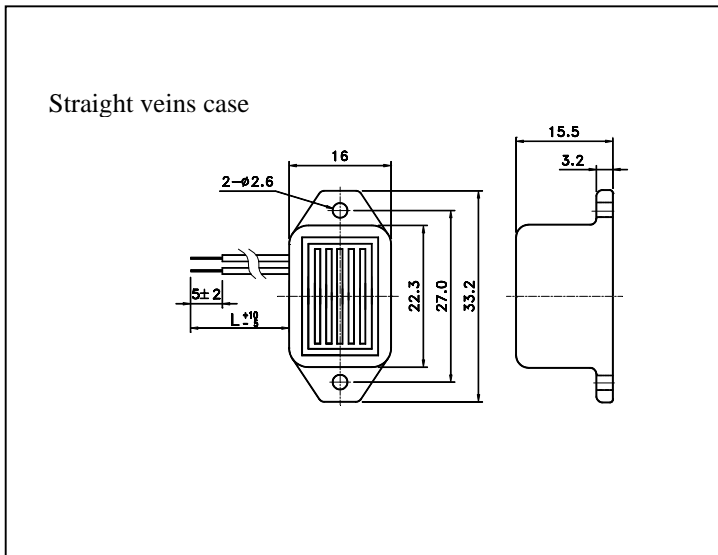

## CHARACTERISTICS:

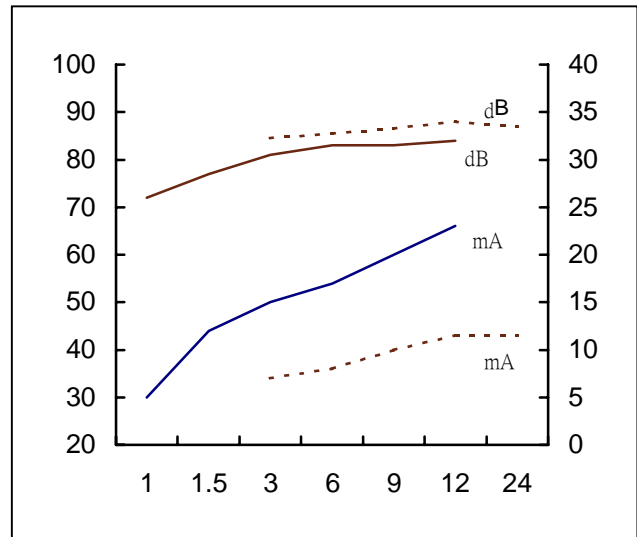

Remark: — Standard - - - - - Hi Current

L=110mm, standard (changes as your request)

## SPECIFICATIONS:

Model No.	Operating Voltage (VDC)	Rated Voltage (VDC)	Max. Current at Rated Voltage (mA)	Min. Sound Pressure at Rated Voltage (dBA/20cm)	Tone	Terminal	Remarks
B8S1060L	3-9	6	20	80	SINGLE	LEAD	STANDARD
B8S1060L	3-9	6	40	85	SINGLE	LEAD	HI CURRENT
B8S1120L	6-16	12	25	80	SINGLE	LEAD	STANDARD
B8S1120L	6-16	12	45	87	SINGLE	LEAD	HI CURRENT

# ECHO-MAGNETIC BUZZER

B8 SERIES



## FEATURES:

- Low pitch sound (400±100Hz)
- Medium to loud sound output
- Operating temperature -20°C--+70°C
- Storage temperature -30°C--+70°C

## DIMENSIONS: (unit: mm)

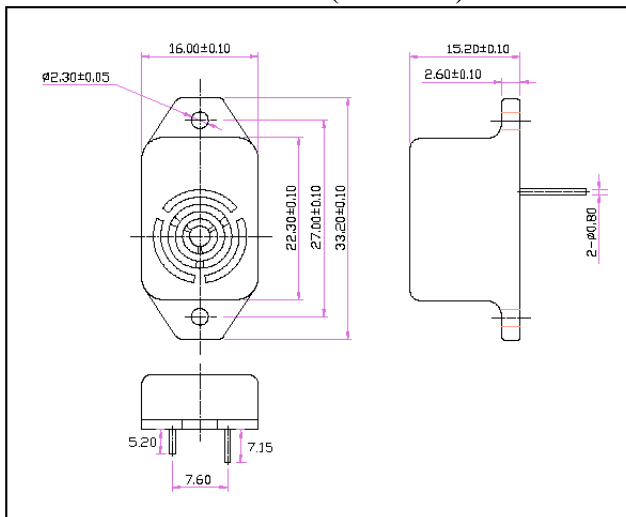

## CHARACTERISTICS:

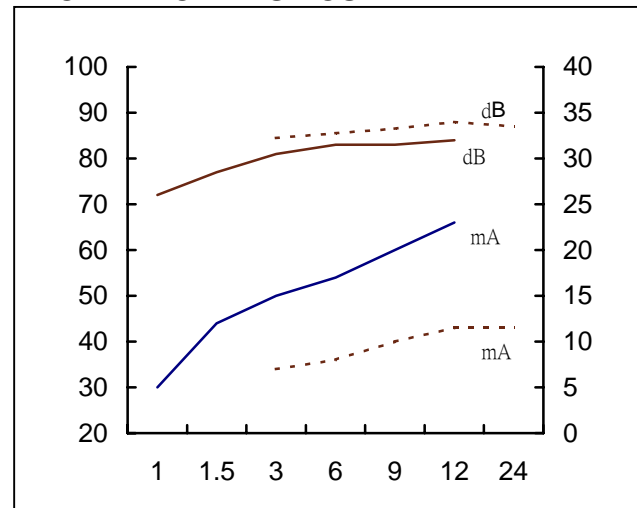

Remark: — Standard    - - - - Hi Current

## SPECIFICATIONS:

Model No.	Operating Voltage (VDC)	Rated Voltage (VDC)	Max. Current at Rated Voltage (mA)	Min. Sound Pressure at Rated Voltage (dBA/20cm)	Tone	Terminal	Remarks
B8S1015P	1.1-1.7	1.5	20	75	SINGLE	PIN	STANDARD
B8S1030P	1.5-4	3	20	80	SINGLE	PIN	STANDARD
B8S1030P(HI)	1.5-4	3	40	80	SINGLE	PIN	HI CURRENT
B8S1060P	3-9	6	20	80	SINGLE	PIN	STANDARD
B8S1060P(HI)	3-9	6	40	85	SINGLE	PIN	HI CURRENT
B8S1090P	4.5-12	9	25	80	SINGLE	PIN	STANDARD
B8S1090P(HI)	4.5-12	9	45	86	SINGLE	PIN	HI CURRENT
B8S1120P	6-16	12	25	80	SINGLE	PIN	STANDARD
B8S1120P(HI)	6-16	12	45	87	SINGLE	PIN	HI CURRENT
B8S1240P	8-30	24	45	85	SINGLE	PIN	STANDARD

# ECHO-MAGNETIC BUZZER

B8 SERIES



## FEATURES:

- Low pitch sound (400±100Hz)
- Medium to loud sound output
- Operating temperature -20°C--+70°C
- Storage temperature -30°C--+70°C

## DIMENSIONS: (unit: mm)

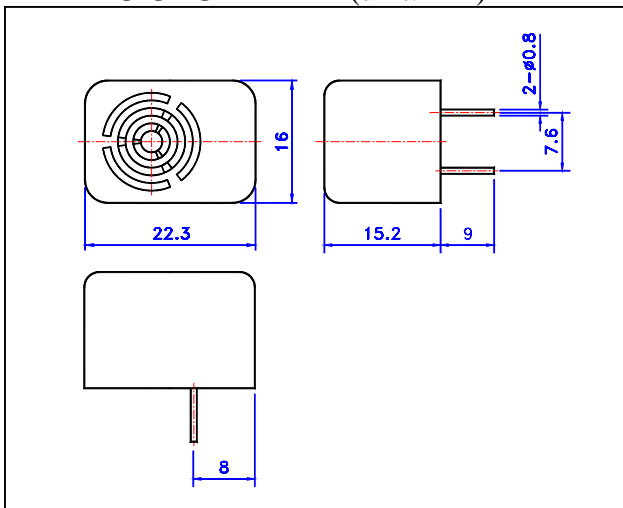

## CHARACTERISTICS:

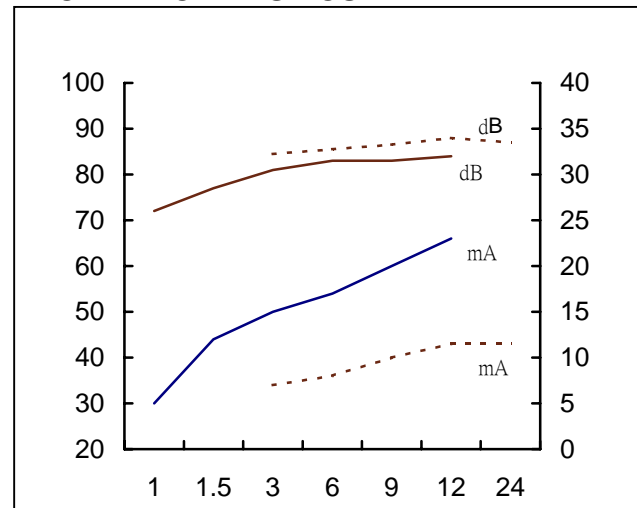

Remark: — Standard    - - - - - Hi Current

## SPECIFICATIONS:

Model No.	Operating Voltage (VDC)	Rated Voltage (VDC)	Max. Current at Rated Voltage (mA)	Min. Sound Pressure at Rated Voltage (dBA/20cm)	Tone	Terminal	Remarks
B8S1015P	1.1-1.7	1.5	20	75	SINGLE	PIN	STANDARD
B8S1030P	1.5-4	3	20	80	SINGLE	PIN	STANDARD
B8S1030P(HI)	1.5-4	3	40	80	SINGLE	PIN	HI CURRENT
B8S1060P	3-9	6	20	80	SINGLE	PIN	STANDARD
B8S1060P(HI)	3-9	6	40	85	SINGLE	PIN	HI CURRENT
B8S1090P	4.5-12	9	25	80	SINGLE	PIN	STANDARD
B8S1090P(HI)	4.5-12	9	45	86	SINGLE	PIN	HI CURRENT
B8S1120P	6-16	12	25	80	SINGLE	PIN	STANDARD
B8S1120P(HI)	6-16	12	45	87	SINGLE	PIN	HI CURRENT
B8S1240P	8-30	24	45	85	SINGLE	PIN	STANDARD